

Four Mile Village Condominium Association

540 S. Forest Street

Water Shut Off Locations

(IMPORTANT: BEFORE TURNING OFF THE WATER TO ANY BUILDING YOU MUST POST A NOTICE ON EACH UNIT DOOR IN THAT BUILDING TO GIVE THEM ADVANCE NOTICE OF WHEN AND HOW LONG THE WATER WILL BE OFF. – In cases of an emergency plumbing repair YOU MUST KNOCK ON EACH UNIT DOOR AND IF THERE IS NO ANSWER POST A WRITTEN NOTICE TO THEIR DOOR)

The following memorandum information was provided by ASL Denver, Inc., Earl Johnson, Management Agent on March 6, 1990:

Each Condominium Building at Four Mile Village has only one (1) water shut off. This shut off will affect the entire building (10 individual units), however, in case of an emergency, you have the following options:

- #1 Call the Association's property management company
- #2 Contact Denver Water Department at (303) 893-2444
- #3 Contact the Fire Department

The location of each water shut off will be important to any Plumber who might be involved in any plumbing situation. Listed below are the locations of all 10 building water shut offs and valves.

<u>BUILDING #</u>	<u>LOCATION</u>
BLDG 10	IN LINE WITH SIGN FOR UNIT 102, 3 FEET NORTH OF SIDEWALK
BLDG 9	IN LINE WITH UNIT 102, ADDRESS SIGN 2 FEET FROM WALK
BLDG 8	3 FEET NORTH OF SIDEWALK
BLDG 7	SOUTHEAST OF HYDRANT IN BETWEEN CONDO BUILDINGS 9 & 10

PLEASE NOTE: BUILDINGS 6, 3, AND 2 HAVE SPRINKLER BACKFLOW DEVICES, WHICH MUST BE SHUT OFF BEFORE THE BUILDING WATER IS SHUT OFF. IF THE SPRINKLER LINES HAVE BEEN SHUT OFF AND WINTERIZED FOR THE SEASON, THIS WILL NOT BE NECESSARY.

- BLDG 6** LOCATED 4 FEET WEST & 20 FEET OF SOUTH WEST CORNER OF BUILDING 8
BACKFLOW LOCATED ON THE EAST SIDE OF BUILDING 6 BETWEEN GARAGE DOORS FOR 6-202 AND 6-201
- BLDG 5** LOCATED 8 FEET WEST OF DRIVE, 4 FEET SOUTH OF WALK, NORTH SIDE OF BUILDING 2
- BLDG 4** LOCATED 25 FEET NORTH AND 20 FEET WEST OF NORTHWEST CORNER OF BUILDING
- BLDG 3** LOCATED IN LINE WITH CENTER OF NORTH WALL OF BUILDING 3 FEET SOUTH OF WALK
BACKFLOW LOCATED ON WEST SIDE OF BUILDING 3 BETWEEN GARAGE DOORS 3-201 AND 3-202
- BLDG 2** LOCATED 1 FOOT WEST OF SILLCOCK ON NORTH WALL OF BUILDING 4 FEET SOUTH OF WALK
BACKFLOW LOCATED ON EAST SIDE OF BUILDING 2 NORTH OF GARAGE DOOR 2-202
- BLDG 1** LOCATED 3 FEET EAST OF STAIRWAY ON NORTH SIDE OF BUILDING

PLEASE KEEP THIS INFORMATION AVAILABLE IN CASE OF ANY PLUMBING ISSUES.
SEE PAGES 3 AND 4 FOR LOCATION MAPS.

Association's Management Company
Wehner Property Management Company
280 S. Madison Street
Denver, CO 80209
(303) 320-8517
Rick Ingraham – rick@russwehner.com
Veronica Krejci – veronica@russwehner.com
Robert Wehner – Robert@russwehner.com

ALL PITS ARE LOCATED THREE FEET BEHIND WALK UNLESS OTHERWISE DENOTED.

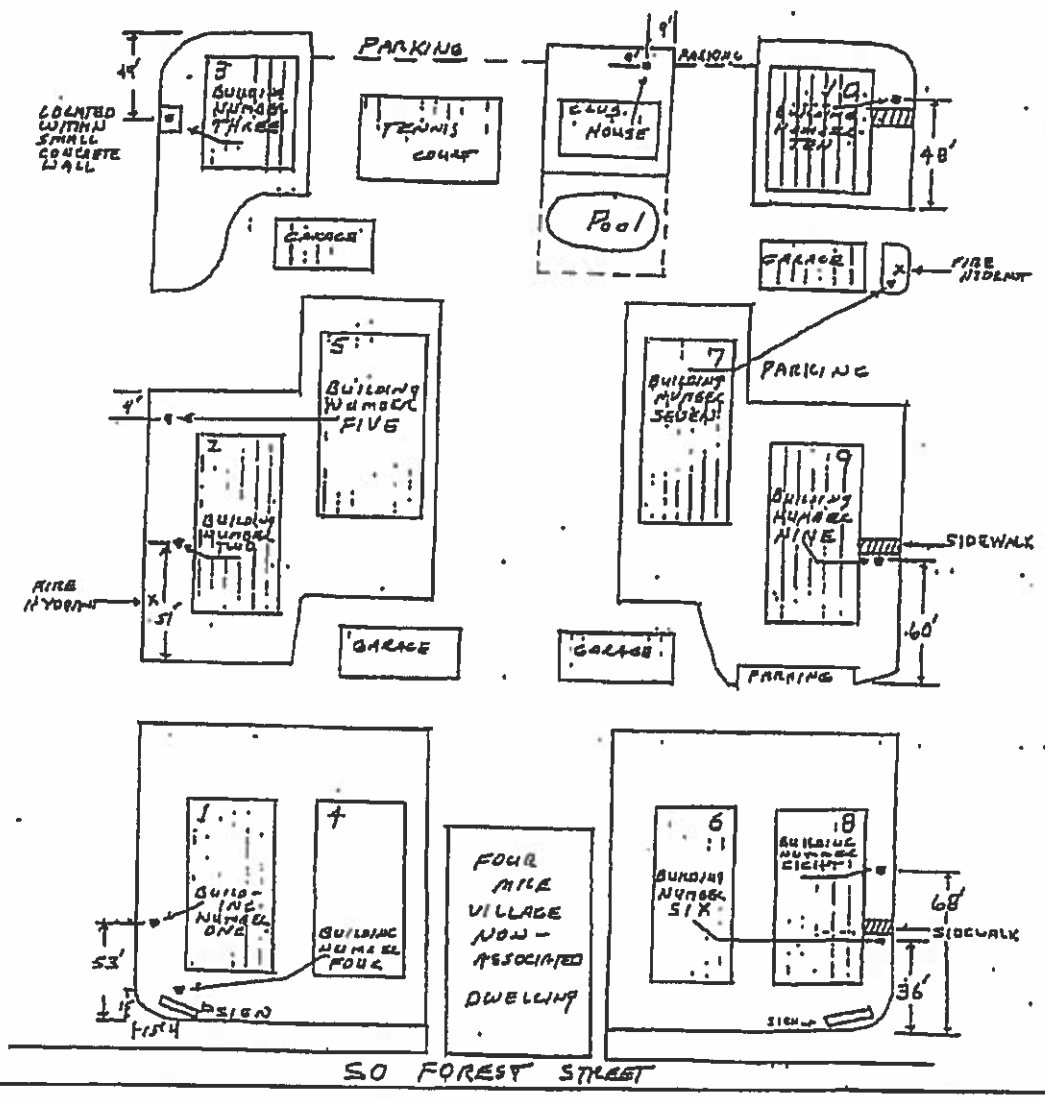

FOUR MILE VILLAGE

OCTOBER 1998

590 50 FOREST ST.

WATEL
METEL LOCATED

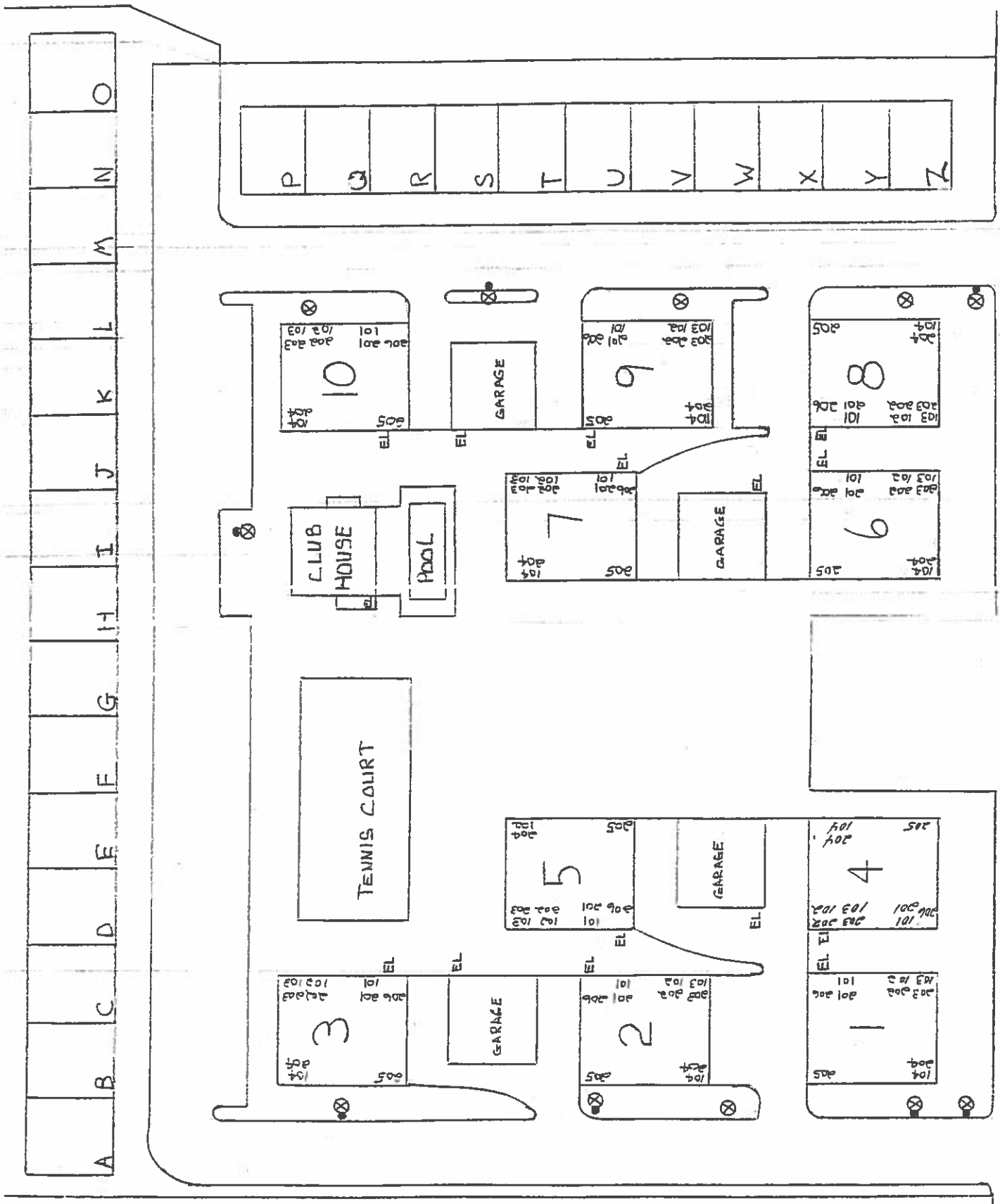

FOUR MILE VILLAGE
EAD & COMPANY CT